

Order at 訂貨熱線 :

香港批發/分銷 T (852) 2781 2855

澳門批發/分銷 T (853) 2822 2751

工程/商業項目 T (852) 2691 9166

E enquiry@supermoon.hk

www.supermoon.hk

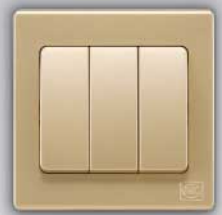
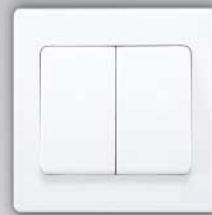

Quality Accessories with Style

# Avant

Catalogue No. R2







# Conform To International Standards

The products are manufactured in an ISO 9001 environment and comply to British / IEC, Malaysia and Singapore standards.

	British Standard / IEC	Malaysia Standard	Singapore Standard
10A/AX Light Switches (10AX switch rating means no need to derate its current rating when connected to fluorescent lamps or inductive loads)	IEC/BSEN 60669	MS IEC 60669	SS 227
20AX DP Switches	IEC/BSEN 60669	MS IEC 60669	SS 227
13A Socket Outlets	BS 1363	MS 589	SS 145
15A Socket Outlets	BS 546	-	SS 472
Fused Connection Units	BS 1363	-	SS 403
Shaver Unit	IEC/BSEN 61558	-	-
25A/45A Connection Unit	BS 5733	-	SS 241
DATA Communication Outlets	BS 5733	-	SS 241
16A Universal Socket Outlet	BS 5733	-	S 241
16A Schuko Socket Outlet	IEC 60884	-	-
45A DP Switch	BSEN 60669	-	-
45A DP Cooker Connection Unit with 13A switches socket	BS 4177	-	-
32A DP Switch	IEC/BSEN 60669	MS IEC 60669	SS 227
Dimmer/Fan Speed Controller	IEC 60669	MS IEC 60669	SS 227
Flush Boxes	S 4662 IEC60670	-	-
Coupler & Spacer	BS 5733	-	SS 241



# An Emblem of Style & Quality

## Avant innovative features and benefits:-

- Ultra slim frontplates of 4mm
- Clip on frontplates which conceal screws
- Frontplates are removable for convenience when painting walls
- Avant light switches are rated at 10AX which means no derating is necessary when used with fluorescent or inductive loads.
- 3mm switch contact gap for increased safety
- International standards – the products are manufactured in an ISO 9001:2000 environment and comply to British, Malaysia and Singapore Standards
- Attractive gloss finish for aesthetic appeal and practical maintenance
- Interchangeable coloured frontplates to suit your interior décor
- 12 years guarantee on all electro-mechanical products (2 years for all electronic products)

## Feature benefits

Available in white, titanium, champagne and charcoal finishes

Provide a range of products that complement the décor of the finest modern and traditional interiors.

Quality gloss finished durable impact resistant plastic front plates

Ensure that the range is durable, tarnish resistant and maintains its stylish and understated appearance.

Core range of sockets, switches and ancillary products

Mean that Avant is suitable for a wide-range of applications.

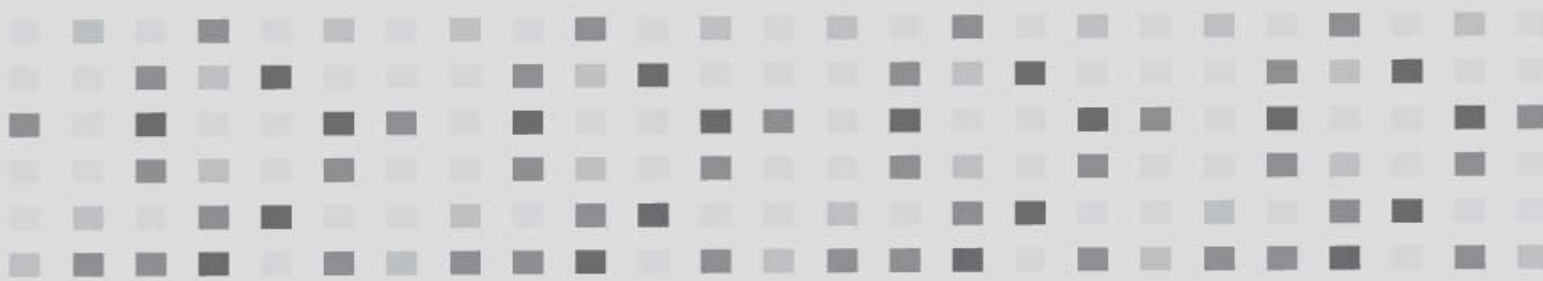
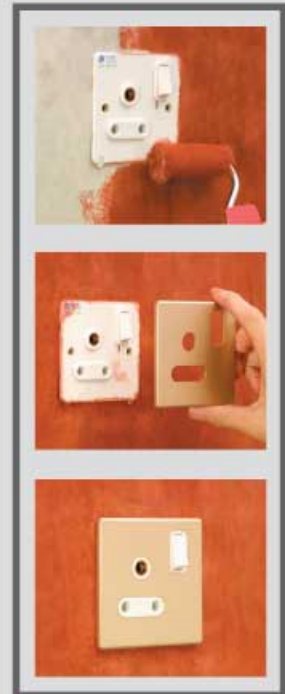

# Standard Rocker Switches

## COLOUR CHOICES



## COLOUR CHOICES



## COLOUR CHOICES



### 1 GANG 1 WAY 10AX SP PLATESWITCH

WHITE	K63870 WHI	CHAMPAGNE	K63870 CHM
CHARCOAL	K63870 CHA	TITANIUM	K63870 TTA

### 1 GANG 2 WAY 10AX SP PLATESWITCH

WHITE	K63871 WHI	CHAMPAGNE	K63871 CHM
CHARCOAL	K63871 CHA	TITANIUM	K63871 TTA



### 2 GANG 1 WAY 10AX SP PLATESWITCH

WHITE	K63872 W1 WHI	CHAMPAGNE	K63872 W1 CHM
CHARCOAL	K63872 W1 CHA	TITANIUM	K63872 W1 TTA

### 2 GANG 2 WAY 10AX SP PLATESWITCH

WHITE	K63872 WHI	CHAMPAGNE	K63872 CHM
CHARCOAL	K63872 CHA	TITANIUM	K63872 TTA



### 3 GANG 1 WAY 10AX SP PLATESWITCH

WHITE	K63873 W1 WHI	CHAMPAGNE	K63873 W1 CHM
CHARCOAL	K63873 W1 CHA	TITANIUM	K63873 W1 TTA

### 3 GANG 2 WAY 10AX SP PLATESWITCH

WHITE	K63873 WHI	CHAMPAGNE	K63873 CHM
CHARCOAL	K63873 CHA	TITANIUM	K63873 TTA



### 1 GANG 1 WAY 10A SP PUSH SWITCH (WITH BELL SYMBOL)

WHITE	K63878B WHI	CHAMPAGNE	K63878B CHM
CHARCOAL	K63878B CHA	TITANIUM	K63878B TTA



### 1 GANG 1 WAY 10A SP PUSH SWITCH (MARKED 'PRESS')

WHITE	K63878P WHI	CHAMPAGNE	K63878P CHM
CHARCOAL	K63878P CHA	TITANIUM	K63878P TTA



### 2 GANG 1 WAY 10A SP PUSH SWITCH WITH NEON MARKED 'AIR CONDITIONER'

WHITE	K63878P/AC/RGN WHI	CHAMPAGNE	K63878P/AC/RGN CHM
CHARCOAL	K63878P/AC/RGN CHA	TITANIUM	K63878P/AC/RGN TTA







COLOUR CHOICES



**1 GANG 1 WAY 20AX DP SWITCH WITH NEON  
(MARKED 'WATER HEATER')**

WHITE	K63423WH WHI	CHAMPAGNE	K63423WH CHM
CHARCOAL	K63423WH CHA	TITANIUM	K63423WH TTA



COLOUR CHOICES



**1 GANG 1 WAY 20AX DP SWITCH WITH NEON**

WHITE	K63423 WHI	CHAMPAGNE	K63423 CHM
CHARCOAL	K63423 CHA	TITANIUM	K63423 TTA



COLOUR CHOICES



**1G 20AX SP INTERMEDIATE PLATESWITCH**

WHITE	K63874 WHI	CHAMPAGNE	K63874 CHM
CHARCOAL	K63874 CHA	TITANIUM	K63874 TTA



# Wide Rocker Switches

## COLOUR CHOICES



## COLOUR CHOICES



## COLOUR CHOICES



### 1 GANG 1 WAY 10AX WIDE ROCKER SP SWITCH

WHITE	K63911 WHI	CHAMPAGNE	K63911 CHM
CHARCOAL	K63911 CHA	TITANIUM	K63911 TTA

### 1 GANG 2 WAY 10AX WIDE ROCKER SP SWITCH

WHITE	K63912 WHI	CHAMPAGNE	K63912 CHM
CHARCOAL	K63912 CHA	TITANIUM	K63912 TTA

### 1 GANG 10AX INTERMEDIATE WIDE ROCKER SP SWITCH

WHITE	K63979 WHI	CHAMPAGNE	K63979 CHM
CHARCOAL	K63979 CHA	TITANIUM	K63979 TTA

### 1 GANG 1 WAY 20AX WIDE ROCKER DP SWITCH

WHITE	K63903 WHI	CHAMPAGNE	K63903 CHM
CHARCOAL	K63903 CHA	TITANIUM	K63903 TTA



### 2 GANG 1 WAY 10AX WIDE ROCKER SP SWITCH

WHITE	K63921 WHI	CHAMPAGNE	K63921 CHM
CHARCOAL	K63921 CHA	TITANIUM	K63921 TTA

### 2 GANG 2 WAY 10AX WIDE ROCKER SP SWITCH

WHITE	K63922 WHI	CHAMPAGNE	K63922 CHM
CHARCOAL	K63922 CHA	TITANIUM	K63922 TTA

### 2 GANG 1 WAY 20AX WIDE ROCKER DP SWITCH

WHITE	K63904 WHI	CHAMPAGNE	K63904 CHM
CHARCOAL	K63904 CHA	TITANIUM	K63904 TTA



### 1 GANG 1 WAY 10AX WIDE ROCKER SP SWITCH WITH NEON

WHITE	K63911N WHI	CHAMPAGNE	K63911N CHM
CHARCOAL	K63911N CHA	TITANIUM	K63911N TTA

### 1 GANG 2 WAY 10AX WIDE ROCKER SP SWITCH WITH NEON

WHITE	K63912N WHI	CHAMPAGNE	K63912N CHM
CHARCOAL	K63912N CHA	TITANIUM	K63912N TTA

### 1 GANG 1 WAY 20AX WIDE ROCKER DP SWITCH WITH NEON

WHITE	K63923 WHI	CHAMPAGNE	K63923 CHM
CHARCOAL	K63923 CHA	TITANIUM	K63923 TTA



### 2 GANG 1 WAY 10AX WIDE ROCKER SP SWITCH WITH NEON

WHITE	K63921N WHI	CHAMPAGNE	K63921N CHM
CHARCOAL	K63921N CHA	TITANIUM	K63921N TTA

### 2 GANG 2 WAY 10AX WIDE ROCKER SP SWITCH WITH NEON

WHITE	K63922N WHI	CHAMPAGNE	K63922N CHM
CHARCOAL	K63922N CHA	TITANIUM	K63922N TTA

### 2 GANG 1 WAY 20AX WIDE ROCKER DP SWITCH WITH NEON

WHITE	K63904N WHI	CHAMPAGNE	K63904N CHM
CHARCOAL	K63904N CHA	TITANIUM	K63904N TTA

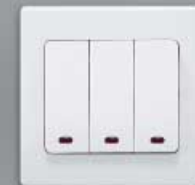

### 3 GANG 1 WAY 10AX WIDE ROCKER SP SWITCH

WHITE	K63931 WHI	CHAMPAGNE	K63931 CHM
CHARCOAL	K63931 CHA	TITANIUM	K63931 TTA

### 3 GANG 2 WAY 10AX WIDE ROCKER SP SWITCH

WHITE	K63932 WHI	CHAMPAGNE	K63932 CHM
CHARCOAL	K63932 CHA	TITANIUM	K63932 TTA

### 3 GANG 1 WAY 10AX WIDE ROCKER SP SWITCH WITH NEON

WHITE	K63931N WHI	CHAMPAGNE	K63931N CHM
CHARCOAL	K63931N CHA	TITANIUM	K63931N TTA

### 3 GANG 2 WAY 10AX WIDE ROCKER SP SWITCH WITH NEON

WHITE	K63932N WHI	CHAMPAGNE	K63932N CHM
CHARCOAL	K63932N CHA	TITANIUM	K63932N TTA

COLOUR CHOICES



**1 GANG 1 WAY 10A WIDE ROCKER SP PUSH SWITCH**

WHITE	K63978 WHI	CHAMPAGNE	K63978 CHM
CHARCOAL	K63978 CHA	TITANIUM	K63978 TTA



COLOUR CHOICES



**1 GANG 1 WAY 10A WIDE ROCKER SP PUSH SWITCH (WITH BELL SYMBOL)**

WHITE	K63978B WHI	CHAMPAGNE	K63978B CHM
CHARCOAL	K63978B CHA	TITANIUM	K63978B TTA



COLOUR CHOICES



**1 GANG 1 WAY 10A WIDE ROCKER SP PUSH SWITCH (MARKED 'PRESS')**

WHITE	K63978P WHI	CHAMPAGNE	K63978P CHM
CHARCOAL	K63978P CHA	TITANIUM	K63978P TTA



**1 GANG 1 WAY 20AX WIDE ROCKER DP SWITCH WITH NEON (MARKED 'WATER HEATER')**

WHITE	K63923WH WHI	CHAMPAGNE	K63923WH CHM
CHARCOAL	K63923WH CHA	TITANIUM	K63923WH TTA

**1 GANG 2 WAY 20AX WIDE ROCKER DP SWITCH WITH NEON (MARKED 'WATER HEATER')**

WHITE	K63725WH WHI	CHAMPAGNE	K63725WH CHM
CHARCOAL	K63725WH CHA	TITANIUM	K63725WH TTA





# Socket Outlets

## COLOUR CHOICES



## COLOUR CHOICES



## COLOUR CHOICES



### 1 GANG 13A SWITCHED SOCKET OUTLET

WHITE	K63757 WHI	CHAMPAGNE	K63757 CHM
CHARCOAL	K63757 CHA	TITANIUM	K63757 TTA



### 2 GANG 13A SWITCHED SOCKET OUTLET

WHITE	K63747 WHI	CHAMPAGNE	K63747 CHM
CHARCOAL	K63747 CHA	TITANIUM	K63747 TTA



### 1 GANG 13A SWITCHED SOCKET OUTLET WITH NEON

WHITE	K63657 WHI	CHAMPAGNE	K63657 CHM
CHARCOAL	K63657 CHA	TITANIUM	K63657 TTA



### 2 GANG 13A SWITCHED SOCKET OUTLET WITH NEON

WHITE	K63647 WHI	CHAMPAGNE	K63647 CHM
CHARCOAL	K63647 CHA	TITANIUM	K63647 TTA



### 1 GANG 13A SOCKET OUTLET

WHITE	K63780 WHI	CHAMPAGNE	K63780 CHM
CHARCOAL	K63780 CHA	TITANIUM	K63780 TTA



### 2 GANG 13A SOCKET OUTLET

WHITE	K63781 WHI	CHAMPAGNE	K63781 CHM
CHARCOAL	K63781 CHA	TITANIUM	K63781 TTA



COLOUR CHOICES



**1 GANG 16A SCHUKO SOCKET OUTLET**

WHITE	K63150 WHI	CHAMPAGNE	K63150 CHM
CHARCOAL	K63150 CHA	TITANIUM	K63150 TTA



**1 GANG 2 PIN 10A UNIVERSAL SWITCHED SOCKET OUTLET**

WHITE	K63155 WHI	CHAMPAGNE	K63155 CHM
CHARCOAL	K63155 CHA	TITANIUM	K63155 TTA



COLOUR CHOICES



**1 GANG 15A SWITCHED SOCKET OUTLET**

WHITE	K63893 WHI	CHAMPAGNE	K63893 CHM
CHARCOAL	K63893 CHA	TITANIUM	K63893 TTA



COLOUR CHOICES



**1 GANG 15A SWITCHED SOCKET OUTLET WITH NEON**

WHITE	K63493 WHI	CHAMPAGNE	K63493 CHM
CHARCOAL	K63493 CHA	TITANIUM	K63493 TTA





# Socket Outlets

## COLOUR CHOICES



### 1 GANG 16A INTERNATIONAL SOCKET OUTLET

WHITE	K63837 WHI	CHAMPAGNE	K63837 CHM
CHARCOAL	K63837 CHA	TITANIUM	K63837 TTA



## COLOUR CHOICES



### 2 GANG 16A INTERNATIONAL SOCKET OUTLET

WHITE	K63838 WHI	CHAMPAGNE	K63838 CHM
CHARCOAL	K63838 CHA	TITANIUM	K63838 TTA

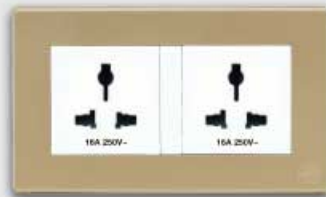

## COLOUR CHOICES



### 1 GANG 16A 2P+1E UNIVERSAL SOCKET OUTLET 250V

WHITE	K63999 WHI	CHAMPAGNE	K63999 CHM
CHARCOAL	K63999 CHA	TITANIUM	K63999 TTA



### 2 GANG 16A 2P+1E UNIVERSAL SOCKET OUTLET 250V

WHITE	K63989 WHI	CHAMPAGNE	K63989 CHM
CHARCOAL	K63989 CHA	TITANIUM	K63989 TTA



### 2 GANG EURO 2 MODULE 50 X 50MM DATA FRONT PLATE

WHITE	K63452 WHI	CHAMPAGNE	K63452 CHM
CHARCOAL	K63452 CHA	TITANIUM	K63452 TTA



### EURO 2 MODULE 50 X 50MM DATA FRONT PLATE

WHITE	K63451 WHI	CHAMPAGNE	K63451 CHM
CHARCOAL	K63451 CHA	TITANIUM	K63451 TTA



Data accessories can be ordered separately:

Blankplate (1 module) SX5452 WHI

Adaptor (1 module) SX5453 WHI

RJ45 Cat 5e Jack SX5454

RJ11 Jack SX5455

RJ12 Jack SX5458

RJ45 Cat 6 Jack SX5457

COLOUR CHOICES



**KEY CARD SWITCH VOLTAGE 220 ~ 240 VAC (50/60Hz)**

WHITE	K63324 WHI	CHAMPAGNE	K63324 CHM
CHARCOAL	K63324 CHA	TITANIUM	K63324 TTA

**KEY CARD SWITCH VOLTAGE 120 VAC (50/60Hz)/12 VDC**

WHITE	K63325 WHI	CHAMPAGNE	K63325 CHM
CHARCOAL	K63325 CHA	TITANIUM	K63325 TTA

**KEY CARD SWITCH VOLTAGE 127 VAC (60Hz)**

WHITE	K63326 WHI	CHAMPAGNE	K63326 CHM
CHARCOAL	K63326 CHA	TITANIUM	K63326 TTA



COLOUR CHOICES



**"SERVICE" AND "DO NOT DISTURB" SWITCH WITH INDICATOR**

WHITE	K63921 SD WHI	CHAMPAGNE	K63921 SD CHM
CHARCOAL	K63921 SD CHA	TITANIUM	K63921 SD TTA

**2 WAY "SERVICE" & "DO NOT DISTURB" SWITCH WITH INDICATOR**

WHITE	K63922 SD WHI	CHAMPAGNE	K63922 SD CHM
CHARCOAL	K63922 SD CHA	TITANIUM	K63922 SD TTA



COLOUR CHOICES



**2 WAY BELL SWITCH WITH SERVICE INDICATOR**

WHITE	K63978 BPSD WHI	CHAMPAGNE	K63978 BPSD CHM
CHARCOAL	K63978 BPSD CHA	TITANIUM	K63978 BPSD TTA





# Data / Voice / TV Outlets

## COLOUR CHOICES



### CABLE TV SOCKET WITH 'F' TYPE CONNECTOR

WHITE	K63529 WHI	CHAMPAGNE	K63529 CHM
CHARCOAL	K63529 CHA	TITANIUM	K63529 TTA



### 1 GANG RJ45 DATA SOCKET OUTLET COMPLETE WITH 1 MODULE BLANKPLATE, ADAPTOR AND RJ45 JACK

WHITE	K63545 WHI	CHAMPAGNE	K63545 CHM
CHARCOAL	K63545 CHA	TITANIUM	K63545 TTA



## COLOUR CHOICES



### 1 GANG RJ11 AMERICAN TYPE (4 WIRE) TELEPHONE SOCKET OUTLET

WHITE	K63817 WHI	CHAMPAGNE	K63817 CHM
CHARCOAL	K63817 CHA	TITANIUM	K63817 TTA



### SINGLE ISOLATED TV SOCKET

WHITE	K63521 WHI	CHAMPAGNE	K63521 CHM
CHARCOAL	K63521 CHA	TITANIUM	K63521 TTA



## COLOUR CHOICES



### 10 WAY TELEPHONE CONNECTOR

WHITE	K63810 WHI	CHAMPAGNE	K63810 CHM
CHARCOAL	K63810 CHA	TITANIUM	K63810 TTA



**COLOUR CHOICES**

**2 GANG CATV / SCV OUTLET**

WHITE	K63528 D1 WHI	CHAMPAGNE	K63528 D1 CHM
CHARCOAL	K63528 D1 CHA	TITANIUM	K63528 D1 TTA

**2M LJU6C DATA FRONT PLATE**

WHITE	K63652 WHI	CHAMPAGNE	K63652 CHM
CHARCOAL	K63652 CHA	TITANIUM	K63652 TTA

Data accessories can be ordered separately:

- LJU 6C Adaptor (1 module) SX5456
- LJU 6C Blankplate (1 module) S170 WHI
- RJ45 Cat 5e Jack SX5454
- RJ11 Jack SX5455
- RJ12 Jack SX5458
- RJ45 Cat 6 jack SX5457

**COLOUR CHOICES**

**SMATV - TV/FM/SATELITE NON ISOLATED TRIPLEXER OUTLET**

WHITE	K63518D WHI	CHAMPAGNE	K63518D CHM
CHARCOAL	K63518D CHA	TITANIUM	K63518D TTA

**COLOUR CHOICES**

**TV / F CONNECTOR**

WHITE	K63855 WHI	CHAMPAGNE	K63855 CHM
CHARCOAL	K63855 CHA	TITANIUM	K63855 TTA





# High Current Switches / Cooker Control Unit / Shaver Unit

## COLOUR CHOICES



## COLOUR CHOICES



## COLOUR CHOICES



### 1 GANG 32A DP SWITCH WITH NEON

WHITE	K63105 WHI	CHAMPAGNE	K63105 CHM
CHARCOAL	K63105 CHA	TITANIUM	K63105 TTA



### 1 GANG 32A DP SWITCH WITH RED ROCKER

WHITE	K63105D1 CHM	CHAMPAGNE	K63105D1 CHM
CHARCOAL	K63105D1 TTA	TITANIUM	K63105D1 TTA



### 45A DP SWITCH WITH NEON MARKED "COOKER"

WHITE	K63605 WHI	CHAMPAGNE	K63605 CHM
CHARCOAL	K63605 CHA	TITANIUM	K63605 TTA



### SHAVER SUPPLY UNIT, 127/230V OUTPUT

WHITE	K63610 WHI	CHAMPAGNE	K63610 CHM
CHARCOAL	K63610 CHA	TITANIUM	K63610 TTA



# Dimmer / Fan Speed Regulator



## COLOUR CHOICES



### 1000W 1 WAY DIMMER WITH ON / OFF FUNCTION

WHITE	K63535 WHI	CHAMPAGNE	K63535 CHM
CHARCOAL	K63535 CHA	TITANIUM	K63535 TTA

### 1000W 1 WAY DIMMER WITHOUT ON / OFF FUNCTION

WHITE	K63536 WHI	CHAMPAGNE	K63536 CHM
CHARCOAL	K63536 CHA	TITANIUM	K63536 TTA



## COLOUR CHOICES



### 500W/200VA 1 GANG 1 WAY ROTARY DIMMER

WHITE	K63501 WHI	CHAMPAGNE	K63501 CHM
CHARCOAL	K63501 CHA	TITANIUM	K63501 TTA



## COLOUR CHOICES



### 200VA 1 GANG FAN SPEED REGULATOR

WHITE	K63601 WHI	CHAMPAGNE	K63601 CHM
CHARCOAL	K63601 CHA	TITANIUM	K63601 TTA





# Connection Units

## COLOUR CHOICES



### 1 GANG 13A UNSWITCHED FUSED CONNECTION UNIT WITH FRONT FLEX OUTLET

WHITE	K63091 WHI	CHAMPAGNE	K63091 CHM
CHARCOAL	K63091 CHA	TITANIUM	K63091 TTA



## COLOUR CHOICES



### 1 GANG 13A SWITCHED FUSED CONNECTION UNIT WITH FRONT FLEX OUTLET AND NEON

WHITE	K63070 WHI	CHAMPAGNE	K63070 CHM
CHARCOAL	K63070 CHA	TITANIUM	K63070 TTA



## COLOUR CHOICES



### 1 GANG 13A SWITCHED FUSED CONNECTION UNIT (WITH BLANKING PLATE INSTEAD OF NEON & COVER CAP FOR BLANKING OFF FLEX OUTLET)

WHITE	K63070BC WHI	CHAMPAGNE	K63070BC CHM
CHARCOAL	K63070BC CHA	TITANIUM	K63070BC TTA



# Blank Plate



## COLOUR CHOICES



### 1G BLANK PLATE

WHITE	K63827 WHI	CHAMPAGNE	K63827 CHM
CHARCOAL	K63827 CHA	TITANIUM	K63827 TTA



## COLOUR CHOICES



### 1 MODULE GRID FRONT PLATE

WHITE	K63801 WHI	CHAMPAGNE	K63801 CHM
CHARCOAL	K63801 CHA	TITANIUM	K63801 TTA



## COLOUR CHOICES



### 2M GRID FRONT PLATE

WHITE	K63802 WHI	CHAMPAGNE	K63802 CHM
CHARCOAL	K63802 CHA	TITANIUM	K63802 TTA



### 3M GRID FRONT PLATE

WHITE	K63803 WHI	CHAMPAGNE	K63803 CHM
CHARCOAL	K63803 CHA	TITANIUM	K63803 TTA



### 4M GRID FRONT PLATE

WHITE	K63804 WHI	CHAMPAGNE	K63804 CHM
CHARCOAL	K63804 CHA	TITANIUM	K63804 TTA

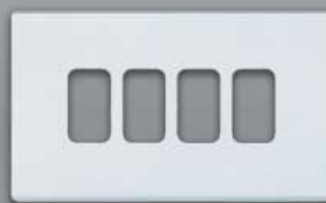

## STANDARD ROCKER SWITCHES

LIST NO.	SURROUND	STANDARD PACK (FG)	PAGE NO.
K63870	KX63100	10	1
K63871	KX63100	10	1
K63872 WI	KX63101	10	1
K63872	KX63101	10	1
K63873 WI	KX63102	10	1
K63873	KX63102	10	1
K63878B	KX63100	10	1
K63878P	KX63100P	10	1
K63878P/AC/RGN	KX63107	10	1
K63423WH	KX63109	10	2
K63423	KX63103	10	2
K63874	KX63100	10	2

## WIDE ROCKER SWITCHES

LIST NO.	SURROUND	STANDARD PACK (FG)	PAGE NO.
K63911	KX63911	10	3
K63912	KX63911	10	3
K63979	KX63911	10	3
K63903	KX63911	10	3
K63921	KX63911	10	3
K63922	KX63911	10	3
K63904	KX63911	10	3
K63931	KX63911	10	3
K63932	KX63911	10	3
K63911N	KX63911	10	3
K63912N	KX63911	10	3
K63923	KX63911	10	3
K63921N	KX63911	10	3
K63922N	KX63911	10	3
K63904N	KX63911	10	3
K63931N	KX63911	10	3
K63932N	KX63911	10	3
K63978	KX63911	10	4
K63978B	KX63911	10	4
K63978P	KX63911	10	4
K63923WH	KX63911	10	4
K63725WH	KX63911	10	4

## SOCKET OUTLETS

LIST NO.	SURROUND	STANDARD PACK (FG)	PAGE NO.
K63757	KX63104	10	5
K63747	KX63105	5	5
K63657	KX63113	10	5
K63647	KX63114	5	5
K63780	KX63111	10	5
K63781	KX63112	10	5
K63150	KX63107	10	6
K63893	KX63106	10	6
K63493	KX63115	10	6
K63155	KX63107	10	6
K63837	KX63107	10	7
K63838	KX63108	5	7
K63999	KX63107	10	7
K63989	KX63108	5	7
K63451	KX63107	10	7
K63452	KX63108	10	7

## HOTEL PACK

LIST NO.	SURROUND	STANDARD PACK (FG)	PAGE NO.
K63324	NA	10	8
K63325	NA	10	8
K63326	NA	10	8
K63921 SD	KX63911	10	8
K63922 SD	KX63911	10	8
K63978 BPSD	KX63911	10	8

## DATA / VOICE / TV OUTLETS

LIST NO.	SURROUND	STANDARD PACK (FG)	PAGE NO.
K63529	KX63110	10	9
K63817	KX63107	10	9
K63810	KX63107	10	9
K63545	KX63107	10	9
K63521	KX63107	10	9
K63528 D1	KX63108	5	10
K63518D	KX63107	10	10
K63855	KX63107	10	10
K63520	KX63107	10	10
K63652	KX63107	10	10

## HIGH CURRENT SWITCHES / COOKER CONTROL UNIT / SHAVER UNIT

LIST NO.	SURROUND	STANDARD PACK (FG)	PAGE NO.
K63105	KX63110	5	11
K63105 D1	KX63110	5	11
K63605	47379SL	1	11
K63610	KX63610	5	11

## DIMMER / FAN SPEED REGULATOR

LIST NO.	SURROUND	STANDARD PACK (FG)	PAGE NO.
K63535	KX63107	1	12
K63536	KX63107	1	12
K63501	KX63107	1	12
K63601	KX63110	1	12

## CONNECTION UNITS

LIST NO.	SURROUND	STANDARD PACK (FG)	PAGE NO.
K63091	KX63110	10	13
K63070	KX63110	10	13
K63070BC	KX63110	10	13

## BLANK PLATE

LIST NO.	SURROUND	STANDARD PACK (FG)	PAGE NO.
K63827	KX63107	10	14
K63801	KX63100	10	14
K63802	48728PL	10	14
K63803	48729PL	10	14
K63804	48730PL	5	14

## COMPONENTS

LIST NO.	DESCRIPTION	NOTES
K63000	1.5 MM THICK MOUNTING FRAME	
K63001	2 GANG SOCKET GASKET	
KX501KB	DIMMER KNOB	
KX107BC	COVER CAP	SUITABLE FOR BLANKING OFF THE FRONT FLEX OUTLET OF CONNECTION UNIT SUITABLE FOR FLUSH & SURFACE MOUNTING OF
KX107F	MOUNTING FRAME	1 GANG PRODUCTS (WITH REMOVABLE INSERTS FOR CABLE ENTRY eg. CONNECTION UNIT)
KX108F	1 GANG 7MM MOUNTING FRAME	
KX109F	2 GANG 7MM MOUNTING FRAME	







---

## **MK ELECTRIC**

---

### **MK Electric (Singapore ) Pte Ltd**

---

8, Pandan Crescent, UE Tech Park #01-06 (LL4), Singapore 128464.	Tel : 65 • 6461 • 6333 Fax : 65 • 6461 • 6336 / 6461 • 6338 Website : <a href="http://www.mkelectric.com.sg">www.mkelectric.com.sg</a>
---	--

---

### **MK Electric (Malaysia) Sdn Bhd (39048-A)**

---

Komplek Perusahaan LTAT, Jalan Pengapit 15/19, 40000 Shah Alam, Selangor Darul Ehsan, Malaysia.	Tel : 603 • 5519 • 2549 / 5519 • 4507 Fax : 603 • 5510 • 8867 Website : <a href="http://www.mkelectric.com.my">www.mkelectric.com.my</a>
--	--

---

### **MK Electric (China) Ltd**

---

25/F, Honeywell Tower, Olympia Plaza, 255 King's Road, North Point, Hong Kong.	Tel : 852 • 2331 • 9133 Fax : 852 • 2151 • 9465 Website : <a href="http://www.mkelectric.com.hk">www.mkelectric.com.hk</a>
---	--

---

### **PT. MK Electric (Indonesia)**

---

Mangga Dua Harco Blok E25, Floor 4, Jakarta 10730.	Tel : 62 • 021 • 625 • 6204 Fax : 62 • 021 • 612 • 1987
---	--

---